

House penetration seals

LEAD THROUGH SEAL, 6510

Our original Sealing Ring F801 is intended as a water seal when embedding a pipe in a concrete wall or floor. It is designed to function trouble free in both high and low water pressure conditions. The F801 is also a so called "movement friendly" seal which allows axial movement of the embedded pipe. The seal can be adjusted after embedment.

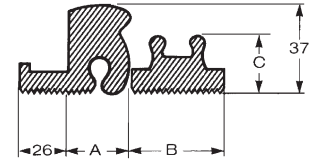

| Dimension | A | B | C |
|-------------|----|----|----|
| DY 110-180 | 25 | 40 | 22 |
| DY 200-1000 | 31 | 50 | 27 |

Lead Through Seal F801 is intended for use as a seal between the pipe and the concrete wall where there is axial movement and/or a great risk of high ground water pressure.

Article No.

6510 +OD HDPE jacket pipe -000-000

An example of how to order:

Lead Through Seal for a pre-insulated pipe DN 200/355, Article No. 6510-355-000-000.

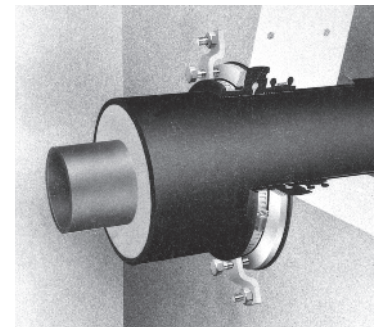

EMBEDMENT RING, 6520

The embedment ring, water barrier F802 is used for water and/or radon sealing when embedding a circular pipe in a concrete wall or floor. It is suitable for all types of piping, for example, plastic, cast iron, steel, concrete etc., and should be mounted directly onto a pipe so that they are cased together. In certain cases the ring can be used on corrugated plastic piping.

The unique profile of the ring, combined with the accompanying hose-clip, provides efficient sealing between the pipe and the concrete. The excellent sealing qualities are partly due to the ability of the hose-clip to hold the rubber ring tightly against the pipe during the casting process. The "ears" of the ring are also fastened completely in the concrete when the concrete hardens. The F 802 ring can advantageously be used when a pipe is not under stress from any axial movement.

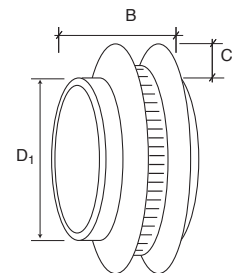

Location of the F802 in concrete

If holes is to be drilled in the concrete wall for later embedding of pipes/rubber ring in concret, we recommend following min. drill holes:

HDPE dim

40-180
≥200

Hole

HDPE Jacket dim. + 100 mm.
 HDPE Jacket dim. + 120 mm.

| Dimension | B | C |
|-------------|----|----|
| DY 63-180 | 40 | 22 |
| DY 200-1000 | 50 | 27 |

Embedment ring is used as a seal between the District Heating pipes and the concrete wall where the axial movement is small.

Article No.

6520-HDPE jacket pipe-000-000

An example of how to order:

Embedment ring for dimension DN 200/355 has Article No. 6520-355-000-000.

When mounting in other types of holes (for example rectangular), there should be a clear space above the rubber ring of 20 mm.

Shut-off valves

T-WRENCH FOR VALVE AND AIR-RELEASE

Article No. 4120-019-027-000.

Wrench size 19 and 27 mm.

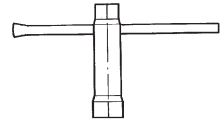

PROTECTION CAP FOR VALVES AND AIR RELEASE UNITS

Article No. 6136 - Dim valve 000-000.

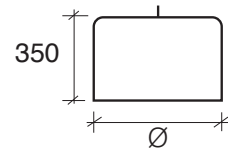

PORTABLE REDUCTION GEAR

| | |
|------------|------------------|
| Valve | Article No. |
| DN 100-150 | 7801-027-000-000 |
| DN 200-400 | 7801-050-000-000 |

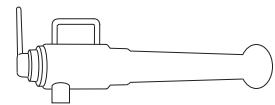

HOT TAPPING VALVE

DN 32-150

Article No. 9260-DN-000-000

| | Length [mm] |
|--------|-------------|
| DN 25 | 209 |
| DN 32 | 207 |
| DN 40 | 226 |
| DN 50 | 262 |
| DN 65 | 280 |
| DN 80 | 312 |
| DN 100 | 352 |
| DN 125 | 265 |
| DN 150 | 305 |

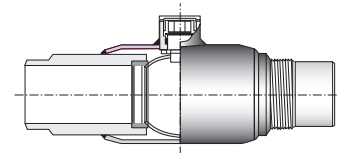

HOT TAPPING TOOL

| | |
|-----------|------------------|
| Valve | Article No. |
| DN 20 | 7871-002-000-000 |
| DN 25-100 | 7871-001-000-000 |

ADAPTER FOR VALVE

| | |
|------------|------------------|
| Dim: | Article No. |
| DN 125-150 | 7871-003-000-000 |

SINGLE USE VALVE

DN 20 - DN 200

Article No. 9247-DN-000-333.

A extendet casing is recommende for the single use valve, see 6:205

| | Length [mm] |
|------------|-------------|
| DN 20-25 | 230 |
| DN 32-40 | 260 |
| DN 50-80 | 300 |
| DN 100-125 | 325 |
| DN 150 | 350 |
| DN 200 | 390 |

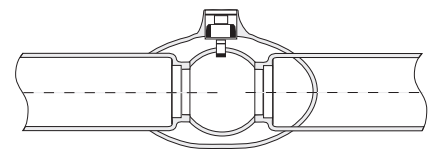

Shut-off valves

SERVICE VALVE FOR SINGLE HOUSE CONNECTION

| | |
|--------------------------|-------------------|
| Copper / internal thread | Ø 15-88, DN 10-25 |
| Copper / copper | Ø 15-54 |
| Welding / copper | DN 15-50, Ø 15-54 |

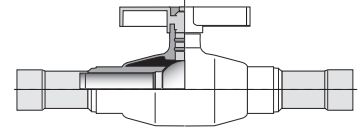

Article No. 9247-DN-000-332.

TWIN VALVE FOR SINGLE HOUSE CONNECTION

| | |
|-----------------------------------|----------------------------------|
| Copper / copper | Ø 18-28 |
| Copper / internal thread | Ø 22 / 3/4" – Ø 28 / 1" |
| Welding / copper | DN 20 / Ø 18, 22, 28 – DN 25 / Ø |
| 22, 28 | |
| Welding / welding | DN 20, 25 |
| Welding / internal thread | DN 20 / 3/4" |
| internal thread / internal thread | 3/4" |

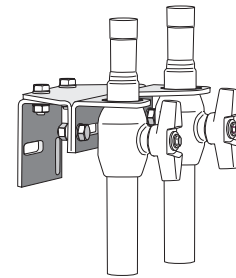

Article No. 7750-DN-000-000.

Miscellaneous

BENDING TOOL TYPE A

Curve radius 2 m. Can be used for dimensions up to DN 80 alt. DN2*50.

Article No. 7860-001-000-000.

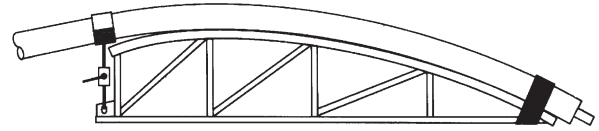

Before use please see "Use and safety instructions"!

ENDING TOOL TYPE B

Curve radius 0.8 m. Used for flexible pipes

Article No. 7860-002-000-000

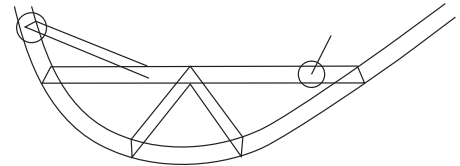

Before use please see "Use and safety instructions"!

PROTECTION NET OF HDPE

Protection net is used as mechanical protection for all joints in exposed environments. Width 1000 mm, thickness 6 mm, 20 meter/roll

Article No. 6190-006-000-000.

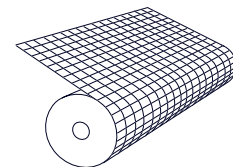

Clips to protection net

Article No. 6190-001-000-000.

WARNING NET

Width 500 mm, length 100 m, purple color

Article No. 6990-000-000-000.

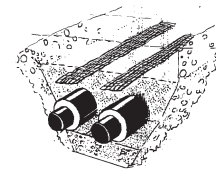

WARNING BAND

Width 150 mm, length 250 m.

Article No. 6990-001-000-000

PLUG FOR JOINTS, NON WELDING TYPE

Dimension 21 mm.

Article No. 6550-035-000-000.

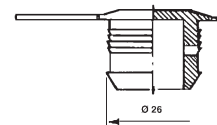

WELDINGPLUGG

Dimension 22 mm. For plugging of foam holes. Requires special tools.

See §10.3.37!

Package size: 2000 pc.

Article No. 6550-050-000-000.

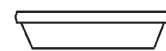

FOPS (COVER PATCH)

Diameter 90 mm. Used to cover weldingplugg to provide extra security.

Package size: 100 pc.

Article No. 6550-012-000-000



WOVEN MASTIC

Width c:a 60 mm. 25 meter/roll.

Article No. 6550-004-000-000.

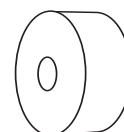

WOVEN MASTIC

Width c:a 100 mm, 25 meter/roll

Article No. 6550-011-000-000

Diverse

WELDING WIRE PEH

Black. Diameter 4 mm. approximately 2 kg/roll

Article No. 9551-001-000-000.

SPACER FOR ALARM WIRE

Length 400mm

Package size: 100 pc.

Article No. 6890-010-000-000.

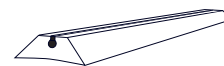

HYGROSCOPIC FELT

400 x 100 mm. Package size: 100 pc.

Art.nr. 6890-011-000-000

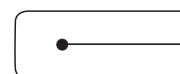

SPLICING SLEEVE FOR ALARM WIRE

Package size: 1000 pc.

Article No. 6890-100-000-000.



INSULATED ALARM WIRE

(For special applications, such as when clamping in real estate, houses).

Article No. 9720-020-000-000

STANDARD ALARM WIRE

Roll with approximately 10 kg. wire. 1,5 mm²

Article No. 9720-000-000-000

RAIL FOR ALARM WIRE (Cable 3 dc)

Box with approximately 100 pc.

Article No. 6890-013-000-000 (for cooling and steam).

SPLICING PLIER

Used to contact-pressure alarm wire in the joint bushing.

Article No. 6890-100-100-000.



POLYOL (DELIVERED IN A DRUM)

A drum contains ~220 kg. For need of smaller quantities please contact

Please study the instruction Chap. 10 prior to use.

Article No. 6706-000-000-000.



ISOCYANATE (DELIVERED IN A DRUM)

Article No. 6720-000-000-000

A drum contains ~250 kg. For need of smaller quantities please contact Powerpipe!

Please study the instruction in Chap. 10 prior to use.

Article No. 6720-000-000-000.

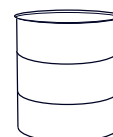

Miscellaneous

MEGGER ISOLATION VOLTAGE TESTER MIT 400
 Article No. 6870-000-000-000.

MEGGER ISOLATION VOLTAGE TESTER 240
 Article No. 6870-000-000-000



PULSE ECHO MEASUREMENT UNIT TYPE TDR 2000-2
 Article No. 6871-000-000-000.



FOAM PADS
 Length 1000 mm, thickness 40 mm, width as desired.
 Article No. 7800-DY-000-000.

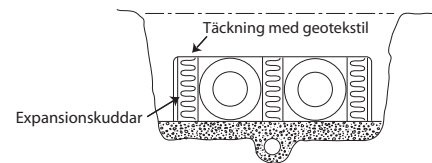

TRANSITION COPPER-STEEL

Straight Ø 22 - DN 20 (26,9)
 Ø 28 - DN 25 (33,7)
 Ø 35 - DN 32 (42,4)

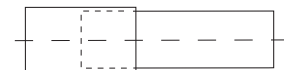

Article No. 6800-ØCu-000-000.

BOX FOR EQUIPMENT AT JOINTING WORK

- Voltage tester
- Plug
- Splicing plier
- Gasnozzle
- Pressuretest equipment..
- Welding equipment
- Splicing sleeves
- fops press
- conical drill

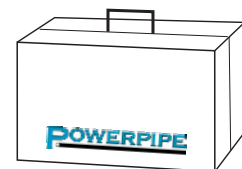

Article No. 9908-000-000-000.

PLUG-WELDING EQUIPMENT

Plug-welding, electronic MSG 41E incl. required equipment.
 Article No. 6890-100-200-000.

BRANCHING PIPE

Used when connecting of double pipe to double pipe.
 Available for DN 25, 32, 40 and 50.

Article No. 8205-DN-000-000.

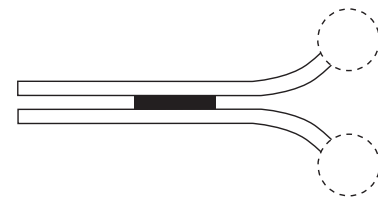

COLD BENDED BEND 5S

Article No. 8201-DN-900-000

ACCESSORIES

8:401

Portion foam Joints, single pipes

Ready to use portion foam for field installation of pre-insulated pipe joints.
The portion foam is delivered in bottles.



PORTION FOAMS, 6480 Dimensioning table for single pipe systems

| Dim. DN [mm] | Series 1 Bottle No. | | | Series 2 Bottle No. | | | Series 3 Bottle No. | | | Series 4 Bottle No. | | |
|--------------------|---------------------|--------|------|---------------------|-----------|------|---------------------|-----------|------|---------------------|-----------|------|
| | PEH Dy | Stand. | Flex | PEH Dy | Stand. | Flex | PEH Dy | Stand. | Flex | PEH Dy | Stand. | Flex |
| 20 | | | | 110 | 3 | 4 | 125 | 4 | 5 | 140 | 6 | 8 |
| 25 | 90 | 2 | 2 | 110 | 3 | 4 | 125 | 4 | 5 | 140 | 6 | 8 |
| 32 | 110 | 3 | 4 | 125 | 4 | 5.1 | 140 | 5 | 5.1 | 160 | 6.1 | 9 |
| 40 | 110 | 3 | 4 | 125 | 4 | 5.1 | 140 | 5 | 5.1 | 160 | 6.1 | 9 |
| 50 | 125 | 4 | 5.1 | 140 | 5 | 6.1 | 160 | 6 | 8 | 180 | 7 | 9.1 |
| 65 | 140 | 4 | 6.1 | 160 | 6 | 8 | 180 | 6.1 | 9 | 200 | 8 | 10 |
| 80 | 160 | 5.1 | 8 | 180 | 6.1 | 8.1 | 200 | 8 | | 225 | 9 | 10.1 |
| 100 | 200 | 6 | | 225 | 8.1 | | 250 | 10 | | 280 | 11 | |
| 125 | 225 | 7 | | 250 | 9 | | 280 | 10.1 | | 315 | 11.1 | |
| 150 | 250 | 8 | | 280 | 10 | | 315 | 11.1 | | 355 | 9.1+9.1 | |
| 200 | 315 | 10 | | 355 | 11.1 | | 400 | 12 | | 450 | 11+11.1 | |
| 250 | 400 | 11.1 | | 450 | 13 | | 500 | 13.1 | | 560 | 12+12 | |
| 300 | 450 | 11.1 | | 500 | 13.1 | | 560 | 13.1+8 | | 630 | 12+13 | |
| 350 | 500 | 13 | | 560 | 13.1+10 | | 630 | 13.1+11.1 | | 710 | 13.1+13.1 | |
| 400 | 560 | 13.1 | | 630 | 13.1+11 | | 710 | 13.1+13.1 | | | | |
| 450 | 560 | 12 | | 630 | 13.1+10 | | 710 | 12+13 | | | | |
| 500 | 630 | 13.1 | | 710 | 13.1+11.1 | | 800 | 13.1+13.1 | | | | |

The "Flex" above refers to T-piece with bend and flexible casing for flexible pipe.

The amounts above are based upon the free casing length 500 mm shrink casing dimensions and temperature +15° C - +40° C on the casing and steel pipe. Foam liquids must have a temperature of approximately 20°C

Article No.

6480-bottle No.-000-000.

An example of how to order:

Bottle size 5.1 has Article No. 6480-051-000-000

**Please observe: Increased amount of foam is needed at cold pipes.
A solution could be to use next bigger size of bottle.**

ACCESSORIES

8:402

Portion foam Joints, double pipes

Ready to use portion foam for field installation of pre-insulated pipe joints.
The portion foam is delivered in bottles.



PORTION FOAM, 6480 Dimensioning table for double pipe systems

| Dimension DN | STANDARD PEH | | DOUBLE+ PEH | | DOUBLE++ PEH | |
|-----------------|-----------------|------------|----------------|------------|-----------------|------------|
| | Dy [mm] | Bottle No. | Dy [mm] | Bottle No. | Dy [mm] | Bottle No. |
| 2 x 20 | 140 | 5 | 160 | 6 | 180 | 7 |
| 2 x 25 | 140 | 5 | 160 | 6 | 180 | 7 |
| 2 x 32 | 160 | 6 | 180 | 6.1 | 200 | 8 |
| 2 x 40 | 160 | 6 | 180 | 6.1 | 200 | 8 |
| 2 x 50 | 200 | 8 | 225 | 8.1 | 250 | 10 |
| 2 x 65 | 225 | 8.1 | 250 | 10 | 280 | 10.1 |
| 2 x 80 | 250 | 10 | 280 | 10.1 | 315 | 11.1 |
| 2 x 100 | 315 | 11.1 | 355 | 9+9 | 400 | 10.1+10.1 |
| 2 x 125 | 400 | 12 | 450 | 13 | 500 | 11.1+12 |
| 2 x 150 | 450 | 13 | 500 | 13.1 | 560 | 12+12 |
| 2 x 200 | 560 | 12+12 | 630 | 11.1+12 | | |

The "Flex" above refers to T-piece for flexible pipe.

The amounts above are based upon the free casing length 500 mm shrink casing dimensions and temperature 15° C - +40° C on the casing and steel pipe. Foam liquids must have a temperature of approximately 20°C

Article No.

6480-bottle No.-000-000.

An example of how to order:

Bottle size 8.1 has Article No. 6480-081-000-000

For calculating relations Polyol/Isocyanat please see 10.3.38

**Please observe: Increased amount of foam is needed at cold pipes.
A solution could be to use next bigger size of bottle.**